



# THE TREE HOUSE

SANTA ROSA BEACH FL





RENOVATION  
DESIGN  
STUDIO

*"The environment attracts the child and the child learns from the materials in the environment."*

The Playground will be separated into designated types of play: ACTIVE and PASSIVE, while both areas should be overall CREATIVE spaces.

**Create opportunities for:**

- **Movement Activities** - running, jumping, balance
- **Quiet Activities** - areas to watch clouds, read, meditate
- **Gardening Activities** - both for agriculture and play: areas to dig, rake, trowel, move dirt and materials along with growing herbs, fruit, and vegetables.
- **Entrance** - an area to brush off before coming inside, sit and listen to teachers before entering playground
- **Observation** - space for teachers to sit and observe students
- Activity tables
- **Structures** - both fixed and buildable
- **Secret paths** - areas to wander with no clear path
- Water interaction

Playground Spacial Standards

Tot Lot - 5,000 sqft

Free Play - 10,000 sqft

Quiet Activities - 6,000 sqft

Proposed: 1/4 acre (10,890 sqft) for ACTIVE play  
 1/4 acre (10,890 sqft) for PASSIVE play  
 1/2 acre (21,780 sqft) for a mixture of both

(1 acre = 43,560 sqft)

**SCHEMATIC MASTER PLAN**  
PLAYGROUND

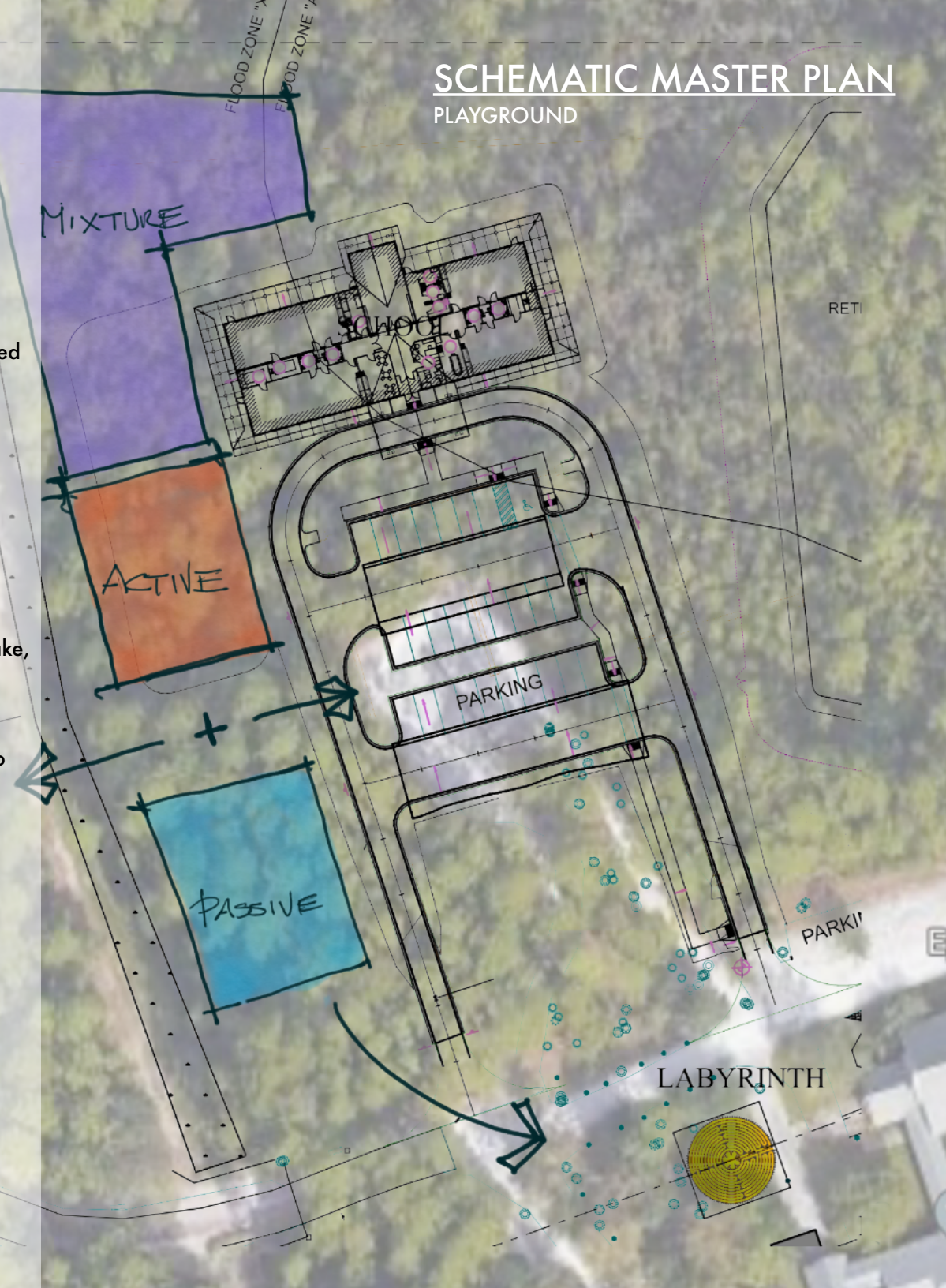





RENOVO  
DESIGN  
STUDIO

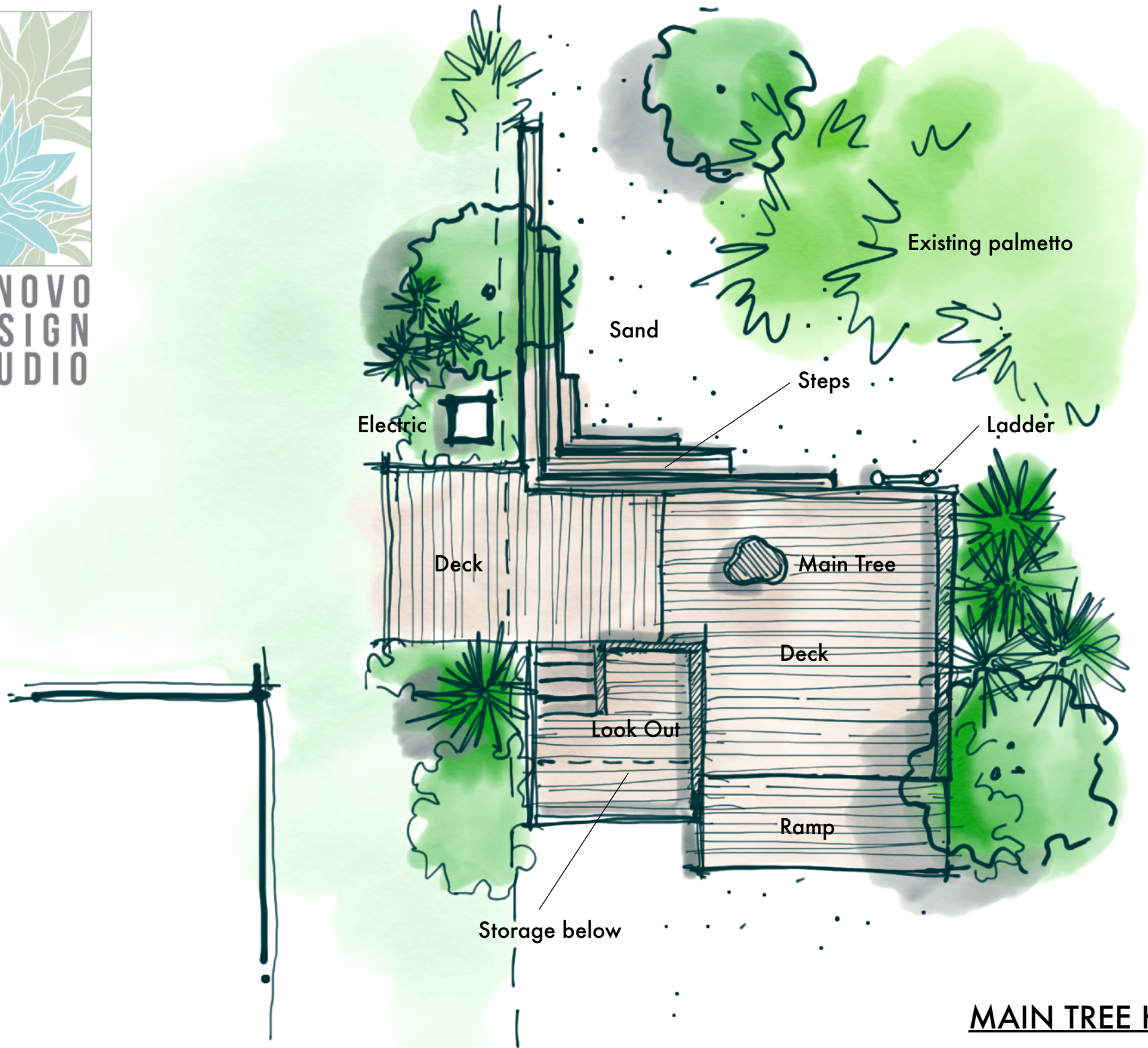

MAIN TREE HOUSE



# LANDSCAPE PALETTE

Native plants are proposed to be added as an understory to the existing trees. These selections are adapted to thrive in dry and wet conditions as well as part shade/sun.

- Rhododendron flammeum 'First Flammeum' (Native Azalea)
- Rhododendron serrulatum (Hammock Azalea)
- Ilex glabra 'compacta' (Compact Inkberry)
- Juncus effusus (Soft Rush)
- Dryopteris ludoviciana (Southern Wood Fern)
- Thelypteris kunthii (Southern Sheild Fern)
- Chrysoma pauciflosculosa (Woody Goldenrod)
- Hymneocallis occidentalis (Spider Lily)
- Iris cristata (Dwarf Crested Iris)
- Lobelia cardinalis (Cardinal Flower)
- Pontederia cordata (Pickerel Weed)
- Gaillardia pulchella (Blanket Flower)
- Zamia pumila (Coontie)













